

SECURITY ENGINEERED MACHINERY

SEM Model 4140CLK, 5140CLK and 5140P Paper Shredder

For More Info

Click Here --->

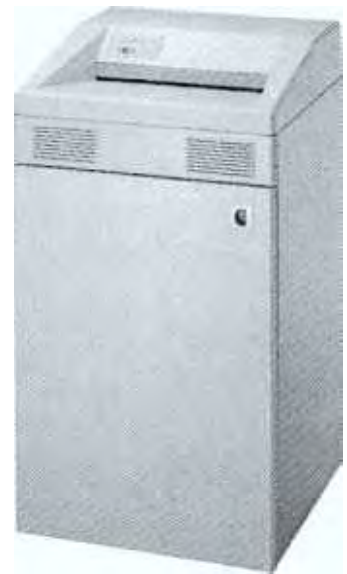

Please read this manual carefully. It will answer all your questions regarding installation, operation and trouble-shooting.

IMPORTANT:

Be sure to adhere to all safety suggestions listed.

Read carefully before using.

THE WORLD LEADER IN DOCUMENT AND SENSITIVE WASTE DESTRUCTION SOLUTIONS

SHREDDERS • DISINTEGRATORS • SECURITY WASTE CONTAINERS • DEGAUSSERS



5 Walkup Drive • Westboro, MA 01581

TABLE OF CONTENTS

READ CAREFULLY BEFORE USING

These Paper Shredders are designed for the in-office destruction of paper documents to an unidentified waste. **Be sure to remove staples and paper clips from the materials to be destroyed.** Proper care and use of your shredder will insure many years of trouble free operation.

Content	Page No.
Installation and Set-up	3
Operation	3
Overloading	3
Door Opening/Bag Full Indicator	4
Lubrication	4
Maintenance	4
Technical Data	4
Using and Ordering Spare Parts	5
Optional Items Available	5
Customer Service	6
Operation	7
Housing Diagram and Parts Breakdown	8-9
Cutting Head Diagrams and Parts Breakdown	10-13
Drive Diagram and Parts Breakdown	14-17
Electric Diagram and Parts Breakdown	18-21

For More Info 

Click Here ---->

For More Info



Click Here --->

IMPORTANT SAFETY PROCEDURES

Your new paper shredder incorporates powerful, heavy duty cutting mechanisms.

Serious and permanent injury may result if proper precautions are not followed.



1. This equipment should never be operated by children or individuals untrained in or incapable of understanding the safety precautions!



2. Do not reach into the feed opening for any reason! Never insert fingers, hands, other extremities or objects not meant to be shredded into the feed openings!



3. Do not operate or come in close proximity to this equipment wearing long hair, necktie, loose clothing or jewelry, which may activate a photoelectric on/off switch and/or be pulled into the machine!



4. Maintenance or repair of this equipment should be performed only by trained, authorized service personnel.

5. Always disconnect electric power (unplug) before removing or opening the cover or other panel giving access to internal mechanisms.

INSTALLATION AND SET-UP

Open the cabinet door by lightly pulling on the upper right corner of the door. Pull the waste box forward and out of the cabinet. Insert the plastic waste bag in the waste box folding the excess over. Push the box in and close the door. Plug Shredder into 20 amp wall outlet.

For More Info



Click Here --->

OPERATION

These models can be operated by turning the switch in the back of the shredder on and by using the 'forward', 'stop', and 'reverse' touch type push buttons. Use these buttons when cleaning the cutter system or to clear a jam.

IMPORTANT: Materials other than common office paper may jam and/or damage the cutting unit. Paper clips and staples should be removed from material being destroyed, to prolong life and trouble-free operation of the cutting unit.

OVERLOADING

If too much paper is fed into the machine, it will switch off automatically. Following a brief pause, the machine will reverse automatically and the excess paper can be easily removed. Thin out the quantity of paper before resuming shredding. If the cutting mechanism is frozen, do not attempt to run the shredder alternately in the forward and reverse modes until the clogged material is released. Call for service.

The motor is protected by a thermal overload device. Should the motor overheat, the thermal overload unit will automatically stop the motor. Should this occur, wait a brief period of time and let the motor cool off.

DOOR OPENING/BAG FULL INDICATOR

For safety reasons, the shredder will not operate when the cabinet door is open. A red indicator light on the control panel will alert the user if the door is ajar.

When the waste bag is full, the shredder will shut off automatically. A red indicator light on the control

panel will alert the user that it is time to change the waste bag.

LUBRICATION

IMPORTANT: To prevent jamming and/or clogging the shredder, it is necessary to frequently lubricate the cutting unit and run it in reverse. For continuous shredding, the unit should be lubricated every 15 minutes.

Alternately run the machine forward and then in reverse several times to clean the cutting unit. Squirt the SEM shred oil directly onto a piece of paper in a figure 8 motion, then feed into machine. Then run it in reverse. This avoids getting oil into the optics. Too much oil is better than not enough. You are again ready to start shredding.

For More Info



Click Here --->

MAINTENANCE

Two to three preventative maintenance calls per year are recommended. Only authorized service personnel should be allowed to service the shredder.

IMPORTANT: Always unplug the shredder before performing any maintenance. If shredding capacity drops or the machine jams easily, clean and lubricate the cutting system as outlined in the "Lubrication" section of this manual.

TECHNICAL DATA

	4140CLK	5140CLK	5140P
Shred Capacity:	up to 11 Sheets	up to 14 Sheets	up to 35 Sheets
Shred Size:	1/32" x 1/2"	1/32" x 7/16"	5/16" x 1-7/8"
Throat Width:	16"	16"	16"
Speed:	20 FPM	30 FPM	40 FPM
Horsepower:	1-1/4HP	2.2 HP	2.2 HP
Dimensions (H x W x D):	41"x22-5/8"x20-3/8"	41"x23-3/4"x21-1/2"	41"x23"x20"
Weight:	195 lbs.	209 lbs.	285 lbs.
Power:	115/1/60	115/1/60	115/1/60

USING AND ORDERING SPARE PARTS

- Only use original SEM spare part replacements
- We guarantee their quality and functional reliability

Warranty claims on parts and/or service must be approved by SEM's Customer Service Manager

HINTS FOR ORDERING SPARE PARTS

The spare parts shown on the following pages have part numbers. This spare parts list shows the following information with respect to the spare parts to be ordered.

- Part No.
- Designation
- Dimensions
- Item No.
- Quantity

In order to avoid errors and the delivery of wrong parts, each parts order should contain the following information.

- Machine Type and Serial No. (See nameplate)
- Part No. and designation of desired spare parts
- Quantity of desired spare parts
- Desired mode of shipment (e.g. post, freight, express)
- Full billing & shipping addresses, including contact person & telephone

OPTIONAL ITEMS AVAILABLE

Replacement Plastic Waste Bags	Part No. 639SB140
Shredder Lubricating Oil, Case of 8 pints,	Part No. 649OIL8
Shredder Lubricating Oil, Case of 16 pints,	Part No. 649OIL16
Shredder Lubrication Oil, Case of 8 40oz bottles	Part No. 649OILCLK (Used w/CLK Models)

For More Info  Click Here ---->

CUSTOMER SERVICE

To order spare parts or optional items you may contact the Authorized Service Rep. for your area, or SEM's Customer Service Dept. directly at the following address:

Security Engineered Machinery
P. O. Box 1045
Westboro, MA 01581

Tel: 800-225-9293

Fax: 508-366-6814

Website: Commerical www.semshred.com

Government www.fedshred.com

Email: info@semshred.com

For More Info

Click Here --->



Please Read and Observe the Operating and Safety Instructions

The machine is designed for shredding smooth sheets of papers. Automatic operation with manual feeding of paper.

INSTALLATION AND CONNECTION

For carrying the machine, use handle rod (12).

The handle rod is located at the left of the substructure. This plug-in unit is ready for operation.

Details on the nameplate (9) - Voltage "V", Frequency "Hz", Current consumption "A" - must be in accordance with the mains supply. Connect the machine to power.

OPERATION

If the green LED (3) illuminates the machine is ready for operation.

Feed paper into the middle of the paper insert (1).

After shredding the machine switches off.

For More Info



Click Here --->

When paper jams in the paper feeder (1):

- Remove paper
- Feed small amount of paper.

Indicator (6) illuminates - waste receptacle (13) is full.

- Open door
 - Press down cut waste into the receptacle. - Pull out receptacle and empty.
- Door switch indicator (7) illuminates - door is open
- Close the door

NOTE:

- Machine is only ready for operation when the door is closed.
- Regularly check the function of the door switch.

If the door is opened, the machine will immediately shut down.

Problem: Start switch (4) doesn't function and green LED (3) does not illuminate.

Remedy: Wait approx. 15 to 20 minutes for motor thermal overload to reset.

Problem: Machine does not automatically switch off.

Remedy: Clean LED (1) with a brush.

For More Info 
Click Here --->

DIAGRAMS
&
PART NUMBERS

For More Info



Click Here ---->

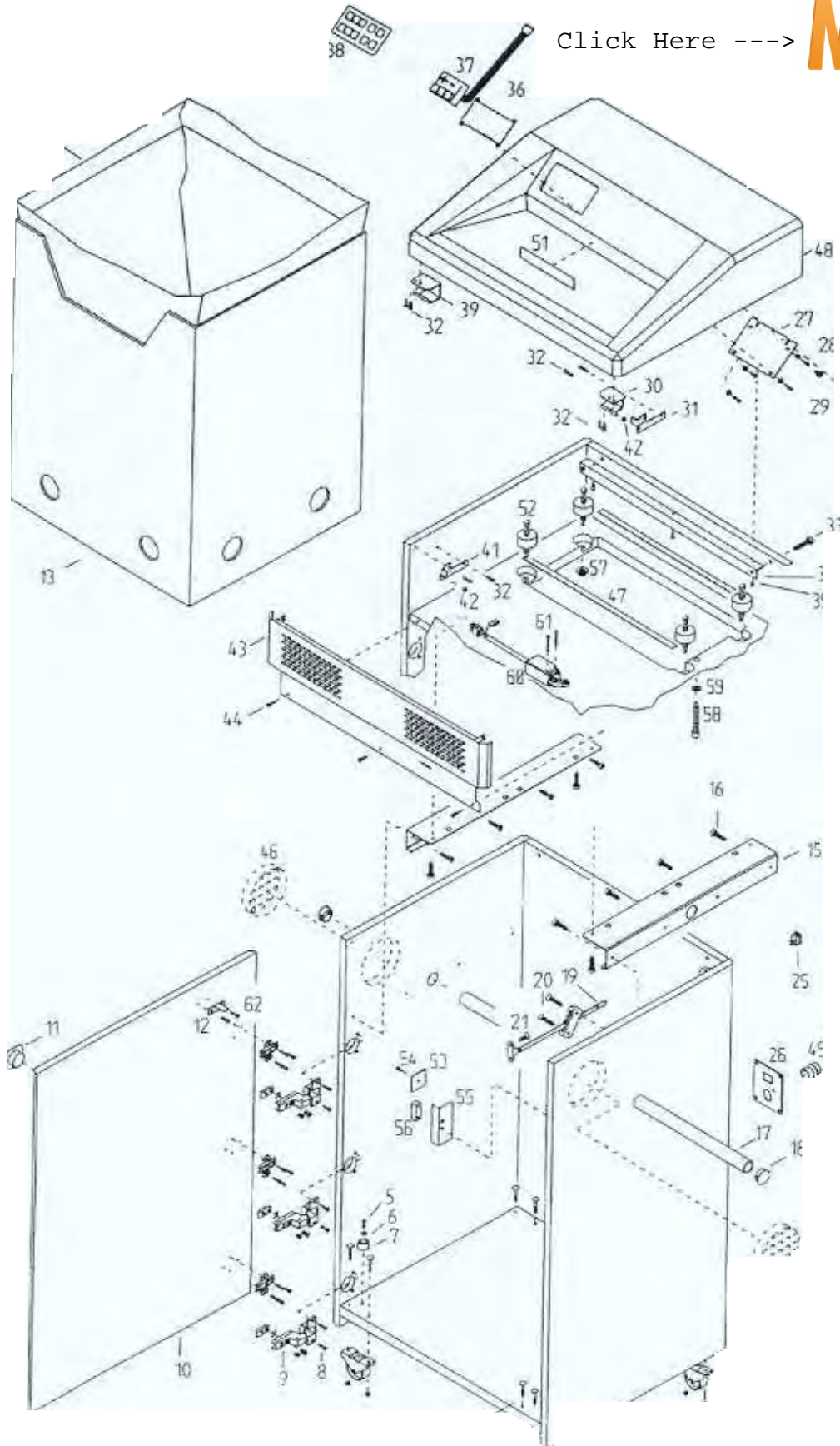

HOUSING PARTS - 4140CLK, 5140CLK, 5140P

Item	Part No.	Designation	Remark	Qty.
1	SE31532004-17	cabinet	incl./door	1
2	SE044260016	caster		4
3	SE042084361	nut	M5	8
4	SE041654305	screw	M5x30	1
5	SE04189 0039	wood screw	M4x20	1
6	SE042302216	washer		1
7	SE042151010	rubber mount		1
8	SE041890030	wood screw	M3.5x15	12
9	SE044453224	hinge		3
10	SE31532003	door		1
11	SE044390020	door handle		1
12	SE41462015	door angle	before serial #153.004999	1
13	SE41536001	collection bin		1
14	639SB140	waste bag	100/box	1
15	SE41532001	cabinet support		2
16	SE041890033	wood screw	M4x14	12
17	SE41410001	lifting tube	d=25x1x774	1
18	SE047580013	hole plug		2
19	SE044460012	cover support		1
20	SE041890021	wood screw	M3x25	2
21	SE041890034	wood screw	M4x15	2
25	SE147520733	on/off switch		1
26	SE41534011	plate		1
27	SE41374019	pushbutton mounting plate		1
28	SE042302209	washer		4
29	SE041863608	screw	M2.9x13	4
30	SE41381029	top cover hinge	right	1
31	SE31412004	top cover hinge mount	right	1
32	SE04890003	screw	M4x16	4
33	SE041340310	screw	M4x8	2
34	SE31412006	angle		1
35	SE041340310	screw	M4x8	3
36	SE41374012	pushbutton backing plate		1
37	SE31534005	pushbutton PC-board		1
38	SE31534008	pushbutton cover		1
39	SE41381030	top cover hinge	left	1
41	SE31412005	top cover hinge mount	left	1
42	SE42507039	spacer		2
43	SE31532003	front grate		1
44	SE041890021	wood screw	M3x25	3
46	SE41381036	vent		2
47	SE41413021	seal		1
48	SE31531001	top cover		1
49	SE044117544	plastic grommet		2
51	SEX9003287	safety label		1
52	SE41533031	mount	after serial #153.005000	4
53	SE41534015	mounting plate	after serial #153.005000	1
54	SE041890029	wood screw	after serial #153.005000	1
55	SEX2201205	casing	after serial #153.005000	1
56	SEX9002984	door open switch	after serial #153.005000	1
57	SE042080624	nut	M8	4
58	SE041201358	screw	M8x40	2
59	SE042342275	washer		2
60	SE31534006	door open switch	before serial #153.004999	1
61	SE041890041	screw	before serial #153.004999	2
62	SE040890011	screw	before serial #153.004999	2

CUTTING MECHANISM - 4140CLK, 5140CLK DoD

For More Info

Click Here --->

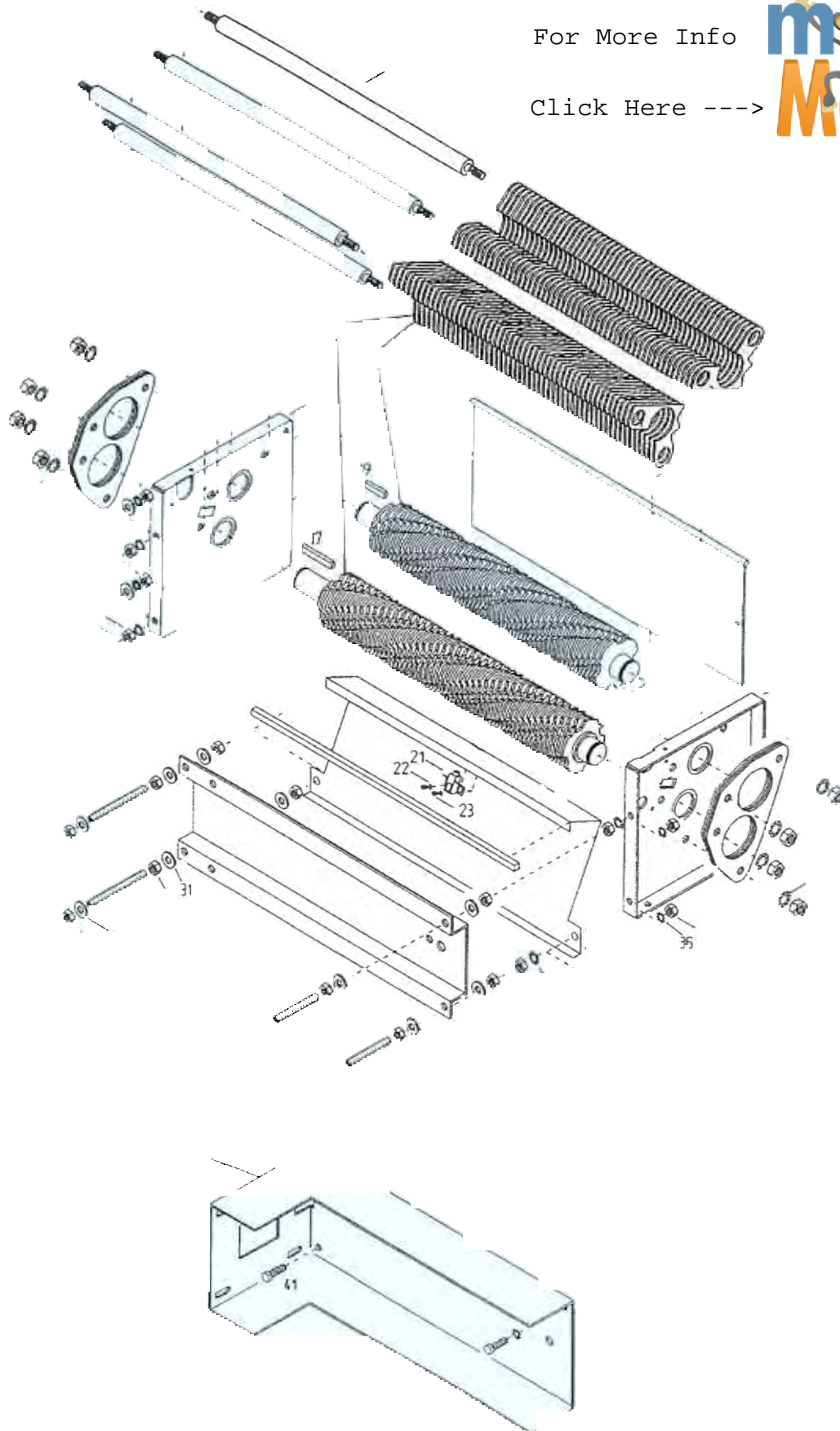

CUTTING MECHANISM - 4140CLK, 5140CLK DoD

Item	Part No.	Designation	Remark	Qty.
	SE41533004	deflector shaft		4
2	SE41533022	deflector	.8 x12 mm	510
3	SE31533004	bag full flap		1
4	SE41533010	end plate	riah	1
5	SE41533008	bearing plate		6
6	SE042462120	washer		8
7	SE042080627	nut	M10	8
10	SE31533016	cover plate		1
15	SE41404027	seal		
16	SE41533009	end plate	left	1
17	SE043264021	key	M8x7x40	1
18	SE31533011	long cutter shaft w/deflectors must be purchased w/Pos #20		1
19	SE043264019	key	M8x7x22	
20	SE31533012	short cutter shaft w/deflectors must be purchased w/Pos #18		1
21	SE41584001	optic holder		1
22	SE042342256	washer		2
23	SE041340302	screw	M3x5	2
30	SE41534001	motor support		1
31	SE042342275	washer	same as Pos # 9	8
32	SE042080624	nut	M8 same as Pos # 8	16
33	SE041601458	threaded shaft	right M8x60	2
34	SE041601460	threaded shaft	left M8x80	2
35	SE042462116	washer		4
36	SE042462116	washer		4

For More Info

Click Here ---->



CUTTING M CHAN M 5 40P CROS CUT

For More Info

Click Here ---->

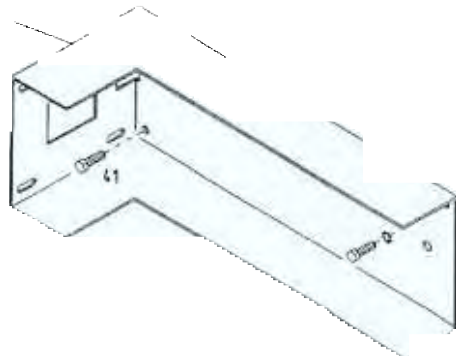
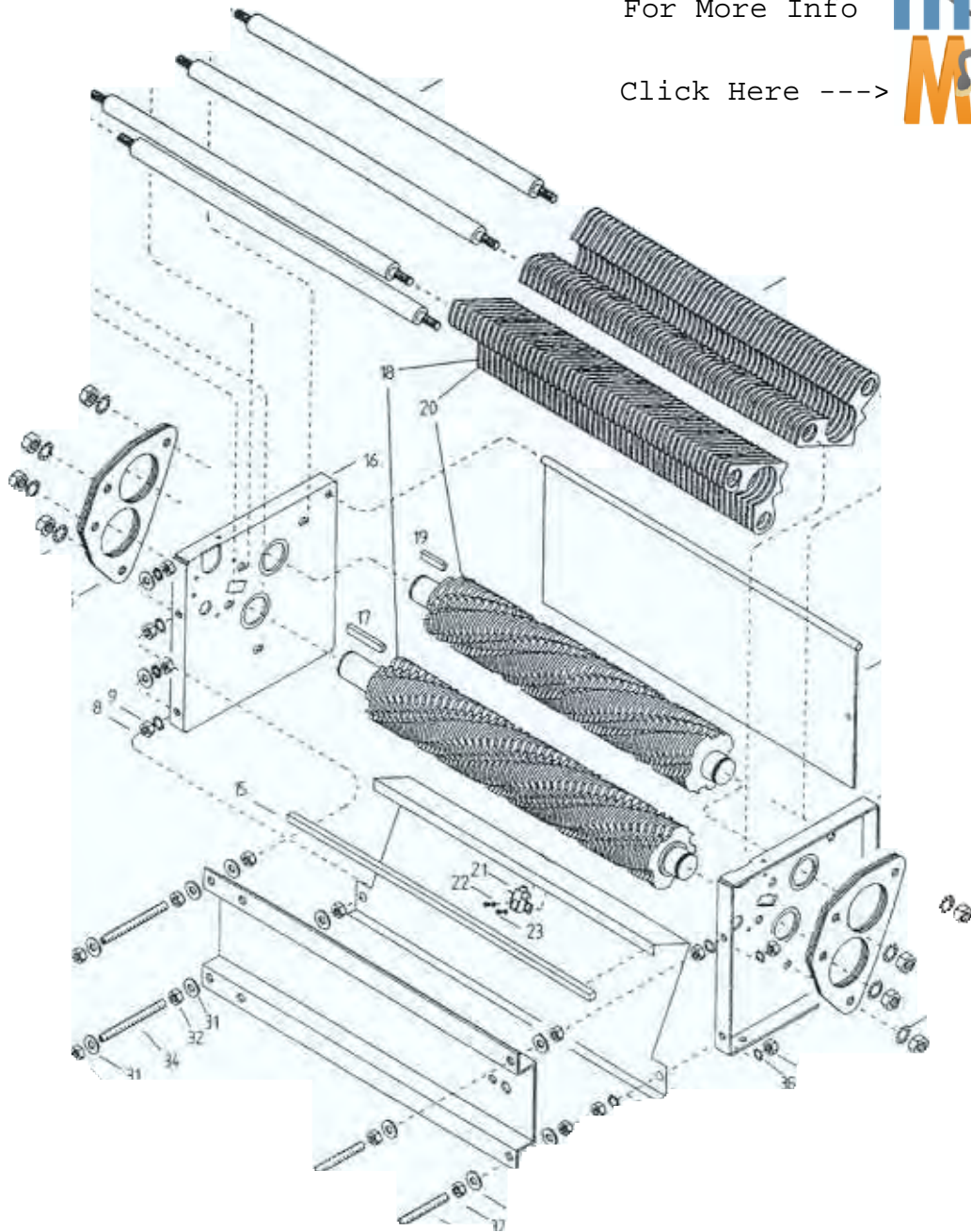

CUTTING MECHANISM - 5140P CROSS CUT

Item	Part No.	Designation	Remark	Qty.
1	SE41533004	deflector shaft		4
2	SE41533015	deflector	3.8x48 mm	102
3	SE31533004	bag full flap		1
4	SE41533010	end plate	right	1
5	SE41533008	bearing plate		6
6	SE042462120	washer		8
7	SE042080627	nut	M10	8
10	SE31533012	cover plate		1
15	SE41404027	seal		1
16	SE41533009	end plate	left	1
17	SE043264021	key	M8x7x40	1
18	SE31533009	long cutter shaft w/deflector must be purchased w/Pos #20		1
19	SE043264019	key	M8x7x22	1
20	SE31533007	short cutter shaft w/deflectors must be purchased w/Pos #18		1
21	SE41584001	optic holder		1
22	SE042342256	washer		2
23	SE041340302	screw	M3x5	2
31	SE042342275	washer	Same as Pos #9	8
32	SE042080624	nut	M8 same as Pos #8	16
36	SE04202102	washer		4
40	SE41534017	motor support		1
41	SE041131354	screw	M8x20	8

For More Info

Click Here ---->



DRIVE - 4140C/CLK

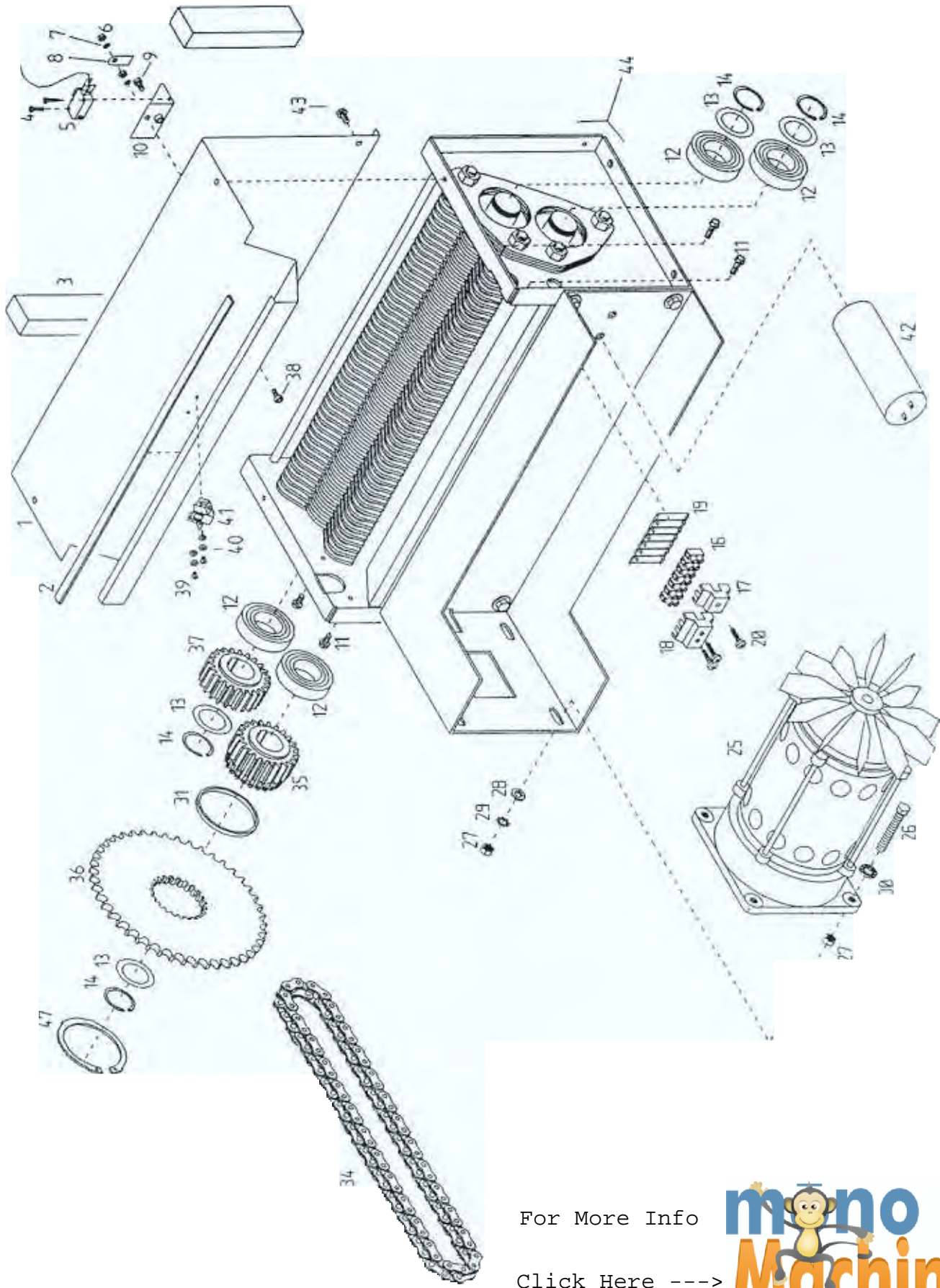

For More Info 
Click Here ---> **Machines**

DRIVE - 4140C/CLK

Item	Part No.	Designation	Remark	Qty.
1	SE41533011	cover plate		1
2	SE41413021	seal		1
3	SE41530007	distance shim		2
4	SE041382704	screw	M3x16	2
5	SE31534010	bag full switch	bag full sensor	1
6	SE042080610	nut	M4	2
7	SE042402102	washer		2
8	SE41534010	bag full switch actuator		1
9	SE041380313	screw	M4x12	1
10	SE31534016	switch mount		1
11	SE041142720	screw	M5x10	8
12	SE046030016	ball bearing		4
13	SE042392287	spacer		4
14	SE042552133	O ring		4
16	SE047590004	Groin		1
17	SE047590005	Cover		1
18	SE047590006	Cover		1
19	SE047590007	Plate		1
20	SE041382715	Screw		3
25	SE9003755	Motor		1
26	SE041131359	Screw		4
27	SE042080624	Nut		8
28	SE042302325	washer		4
29	SE042402116	spring tooth disc		4
30	SE042462116	fuse		4
31	SE41703013	ring		1
34	SE41534019	chain		1
35	SE41533007	toothed wheel	z=23	1
36	SE41533032	chain wheel	z=39	1
37	SE41533006	toothed wheel	z=23	1
38	SE041380313	lens screw		1
39	SE041340302	countersunk scREW		2
40	SE042342256	washer		2
41	SE41584001	support		1
42	SE047680035	capacitor		1
43	SE041142722	screw		2
44	SE31533021	cutting head		1
47	SE042552160	locking ring		1
50	SE9004393	interference filter		
51	SE041382708	lens screw		
52	SE042302213	washer		

For More Info

Click Here --->



DRIVE - 5140CLK AND 5140P

Item	Part No.	Designation	Remark	Qty.
1	SE41533011	cover plate		1
2	SE41413021	seal		1
3	SE41530001	distance shim		2
4	SE041382704	screw	M3x16	2
5	SE31534010	bag full switch	bag full sensor	1
6	SE042080610	nut	M4	2
7	SE042402102	washer		2
8	SE41534010	bag full switch actuator		1
9	SE041380313	screw	M4x12	1
10	SE31534016	switch mount		1
11	SE041142720	screw	M5x10	8
12	SE046030016	ball bearing		4
13	SE042392287	spacer		4
14	SE042552133	O ring		4
15	SE042080624	nut	M8	5
16	SE042342275	washer		5
17	SE41374009	speed detector mount	before serial # 153.004999	1
18	SE41374017	threaded plate	before serial # 153.004999	1
19	SE042302213	washer	before serial # 153.004999	2
20	SE041380310	screw	before serial # 153.004999	2
21	SE41434013	distance ring	before serial # 153.004999	2
22	SE31374010	speed detector	before serial # 153.004999	1
23	SE042462106	washer	before serial # 153.004999	2
24	SE041380342	screw M3x12	before serial # 153.004999	2
26	SE41374018	threaded plate	before serial # 153.004999	1
27	SE041380311	screw	M4x8	3
29	SE147510057	motor w/gear box		1
30	SE042342275	washer		4
31	SE041131358	screw	M8x35	2
32	SE41534004	sprocket z=16	before serial # 6081122	1
32	SE41534007	sprocket z=13	after serial # 6081122	1
33	SE042552127	O ring		1
33	SE41534002	chain	after serial # 6081122	1
34	SE41534003	chain	before serial # 6081122	1
35	SE41533007	timing gear	long z=23	1
36	SE41533005	sprocket		2
37	SE41533006	timing gear	z=23	1
38	SE041380313	screw	M4x12	1
39	SE41584001	optic holder		1
40	SE042342256	washer		2
41	SE041340302	screw	M3x15	2
42	SE047680036	capacitor	80UF	1
43	SE041142722	hexagon screw		2
44	SE31533002	cutting head complete	5140P	1
44	SE31533003	cutting head complete	5140C before sn 6081122	1
44	SE1201106	cutting head complete	5140C after sn 6081122	1
45	SE31484001	speed detector magnet	before serial # 153.004999	1
46	SE041201356	screw M8x30	before serial # 153.004999	1
47	SE042552160	O ring		

ELECTRIC DIAGRAM 4140CLK, 5140CLK, 5140P

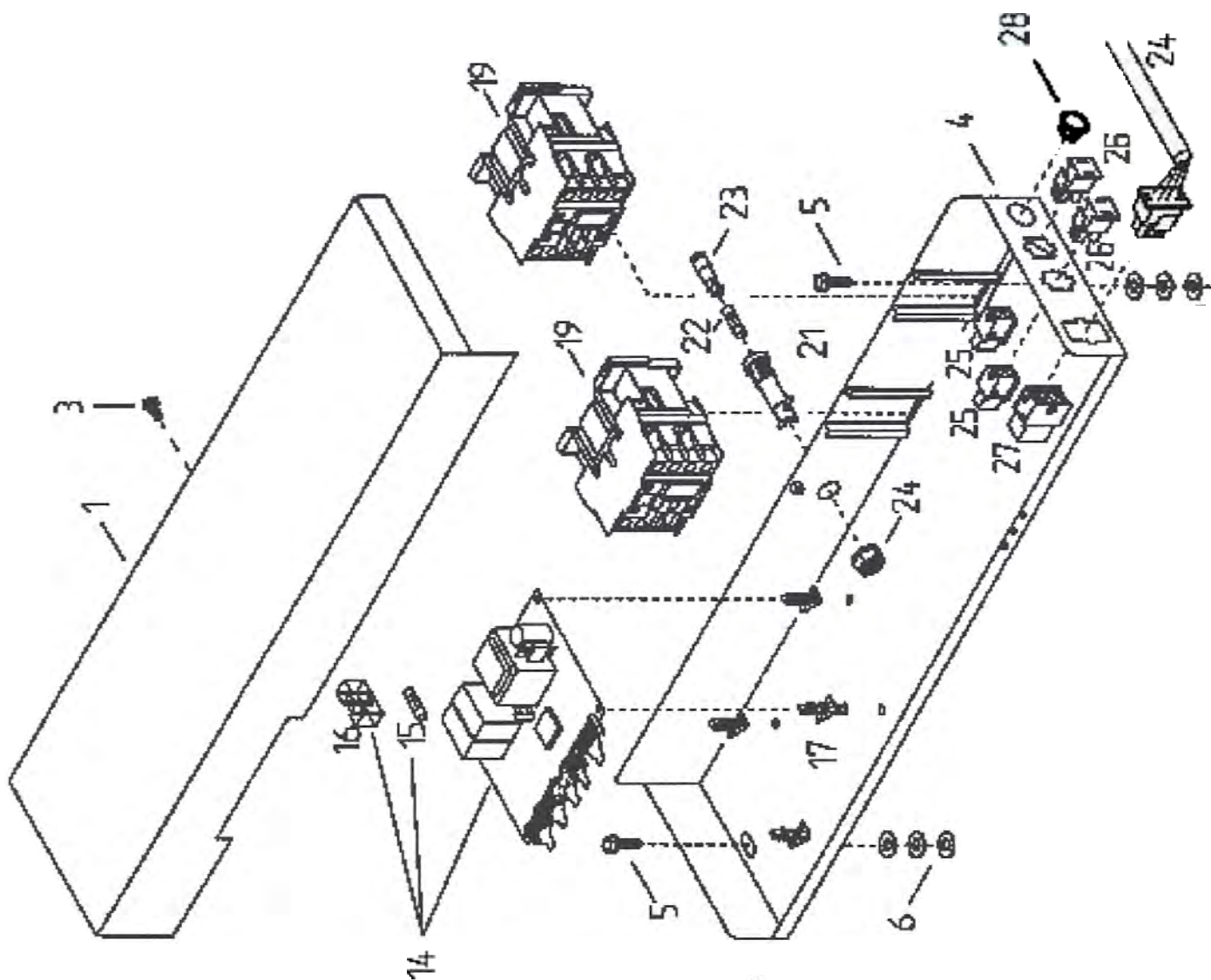

For More Info



Click Here --->

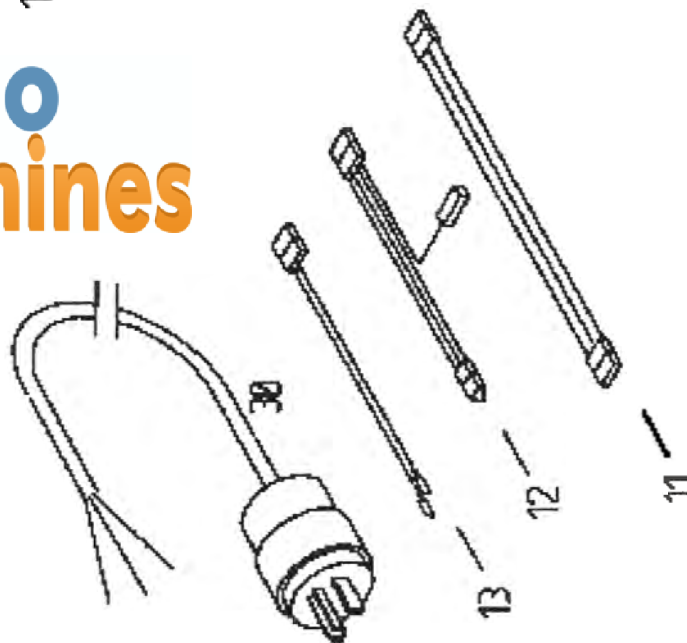

ELECTRIC PARTS - 4140CLK, 5140CLK, 5140P

before serial #153.004999

Item	Part No.	Designation	Remark	Qty.
1	SE41534006	cover		1
3	SE041380316	screw	M4x10	1
4	SE31534009	electrical housing		1
5	SE041142722	screw	M5x16	2
6	SE042302216	washer		6
11	SE30105314	cable		1
12	SE31534007	optics		1
13	SE30105280	cable		1
14	SE31534004	PC-board		1
15	SE047600020	fuse	8 MA	1
16	SE047600049	cover		1
17	SE047630020	circuit board standoff		4
19	SE147521025	contactor	110-125V	2
21	SE047600042	fuse holder		1
22	SE047600005	fuse	2 A	1
23	SE047600043	fuse lock		1
24	SE30104622	cable awg 16-	110-125V	1
25	SE147560109	pin connector 2-pole		2
26	SE147560108	pin connector 2-pole		2
27	SE147560154	pin connector 6-pole		1
28	SE147560153	pin connector 6-pole		1
30	SE30105337	power cord 14 awg		1

For More Info 
Click Here --->

ELECTRIC DIAGRAM - 4140CLK, 5140CLK, 5140P

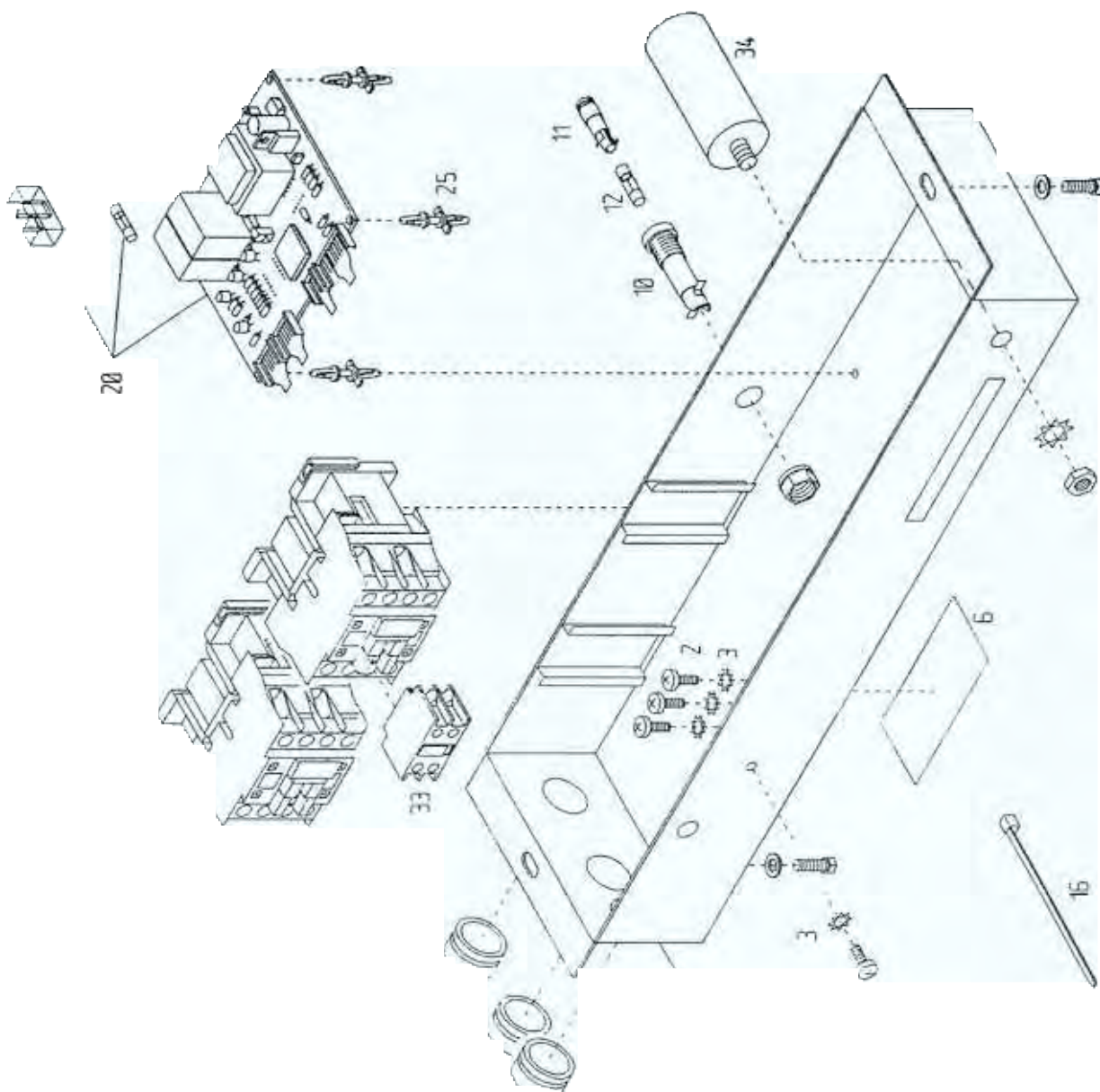

For More Info



Click Here --->

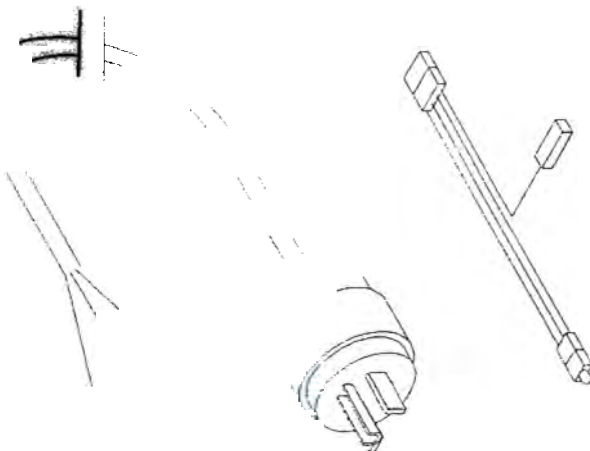

ELECTRIC PARTS - 4140CLK, 5140CLK, 5140P

after serial #153.005000

Item	Part No.	Designation	Remark	Qty.
1	SE31534024	electrical housing		
2	SE041382708	screw	M4x16	4
3	SE042402102	washer		4
4	SE041142721	screw	M5x12	2
5	SE042302219	washer		2
6	SE044720003	plate: before opening cover		1
10	SE047600042	fuse holder		
11	SE047600043	fuse lock		1
12	SE047600005	fuse	2 A	1
15	SEX9002194	grommet		3
16	SE047540092	wire tie		
17	SE31534007	optics		1
20	SE31534022	PC-board		1
22	SE047600020	fuse	8 MA	1
24	SE047600049	cap		1
25	SE047630022	circuit board standoff		4
30	SE147521025	contactor	100-125V	2
33	SE147521055	contactor		1
34	SE047680013	capacitor		1
42	SE30105358	power cord 14 awg	100-125V	1

For More Info 
Click Here --->

ADDITIONAL SEM PRODUCTS



Automatic Oiler

For More Info

Click Here --->



Disintegrators/Industrial Shredders



Magnetic Media Degaussers



Recycling Collection Containers and Specialty Waste Receptacles

For detailed products information including all application and specifications contact

Customer Service at 1-800-225-9293

or via the web

Government www.fedshred.com or

Commercial www.semshred.com

THE WORLD LEADER IN DOCUMENT AND SENSITIVE WASTE DESTRUCTION SOLUTIONS

SHREDDERS • DISINTEGRATORS • SECURITY WASTE CONTAINERS • DEGAUSSERS



5 Walkup Drive • Westboro, MA 01581