

For More Info



Click Here ---->

SECURIO®

SCHÖN SICHER.



SECURIO®

B34

BETRIEBSANLEITUNG
AKTENVERNICHTER

OPERATING INSTRUCTIONS
PAPER SHREDDER

NOTICE D'UTILISATION
DESTRUCTEUR DE DOCUMENTS

MANUALE OPERATIVO
DISTRUGGIDOCUMENTI

INSTRUCCIONES DE SERVICIO
DESTRUCTORA DE DOCUMENTOS

INSTRUÇÕES DE OPERAÇÃO
DESTRUIDORA DE DOCUMENTOS

GEBRUIKSAANWIJZING
PAPIERVERNIETIGER

BRUGSVEJLEDNING
MAKULERINGSMASKINE

BRUKSANVISNING
DOKUMENTFÖRSTÖRARE

KÄYTTÖOHJE
PAPERINSILPPURI

BRUKSANVISNING
MAKULERINGSMASKIN



HSM®

1.840.998.100 – 0807

SECURIO® B34

deutsch:	Aktenvernichter SECURIO B34	3
english:	Paper shredder SECURIO B34	9
français:	Destructeur de documents SECURIO B34	15
italiano:	Distruggidocumenti SECURIO B34	21
español:	Destrucción de documentos SECURIO B34	27
português:	Destruída de documentos SECURIO B34	33
nederlands:	Papiervernietiger SECURIO B34	39
dansk:	Makuleringsmaskine SECURIO B34	45
svenska:	Dokumentförstörare SECURIO B34	51
suomi:	Paperinsilppuri SECURIO B34	57
norsk:	Makuleringsmaskin SECURIO B34	63

HSM (UK) Ltd.

14 Attwood Road / Zone 1
Burntwood Business Park
Burntwood
Staffordshire
WS7 3GJ

Tel. +44(0) 1543.272.480
Fax +44(0) 1543.272.080
info@hsmuk.co.uk
www.hsmuk.co.uk



HSM GmbH + Co. KG

Bahnhofstrasse 115
88682 Salem / Germany

Tel. +49 (0) 75 53 / 822-0
Fax. +49 (0) 75 53 / 822-160
info@hsm.eu
www.hsm.eu

HSM of America LLC

1075 Andrew Drive, Suite C
West Chester
PA 19380

Tel. (610) 918-4894
(1200) 613-2110
Fax (610) 918-4899
customerservice@hsmofamerica.com
info@hsmofamerica.com
www.hsmofamerica.com

1 Proper use, warranty

The shredder is designed exclusively for destroying paper. Depending on the cutting type, it can also handle small quantities of the following materials:

Shred width (mm)	3.9	5.8	1.9x15	4.5x30
Credit and charge cards	•	•	•	•
CDs	•	•		•

Its sturdy drive mechanism is not damaged by paper clips and staples.

The warranty period for the document shredder is 2 years. In addition, there is a 10 year guarantee on the solid steel blade rollers. This warranty and guarantee exclude wear and damage caused by improper handling or actions taken by third parties.

2 Safety instructions

- Read the operating instructions before switching on the document shredder. Save these instructions for later use.
- Follow all warnings and instructions marked on the product!



Risk of injury!

Do not reach into the paper feed slot.



Risk of injury from being pulled in!

Keep long hair, loose articles of clothing, ties, scarves, jewellery, etc. away from feed opening. Material with the tendency to form loops, e.g. tapes, strapping material, etc. must not be shredded.



Danger of injury by splinters!

Feed CDs through the slot in the safety element only.



Keep paper shredder out of the reach of children. Do not let the shredder run if the person using it is not present.

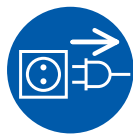

Switch the shredder off and disconnect it from the mains if it is damaged, not working correctly or before relocating or cleaning it.



Service work may only be carried out by HSM Customer Service or by the service technicians of our contractual partners.

- Make sure the mains plug is easily accessible.
- Before plugging in the mains plug, check that the voltage and frequency of your local mains supply correspond to those stated on the type plate.
- This paper shredder should never be placed near or over a radiator or heat source. The ventilation slots must not be blocked or covered and they must be at a distance of at least 5 cm away from walls or furniture.
- Make sure no liquid is spilled on or in the paper shredder.

SECURIO® B34

3 Machine components

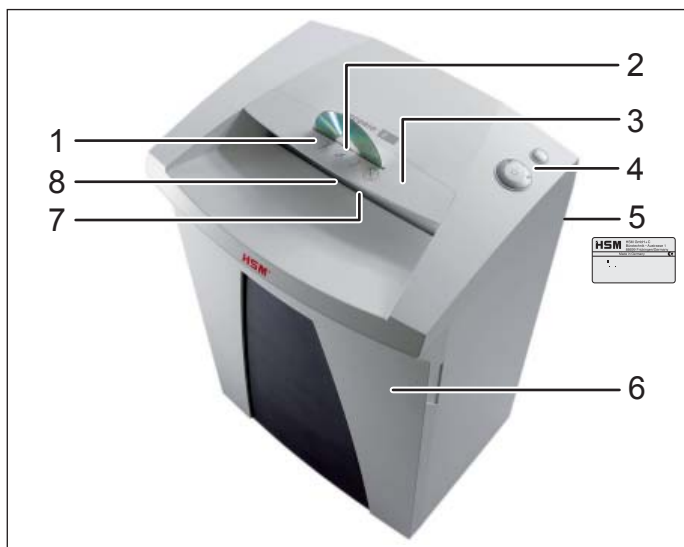

- 1 Safety instructions
- 2 Feed opening for CDs
- 3 Safety element / splinter protection
- 4 Operating and display unit
- 5 Name plate
- 6 Door
- 7 Feed opening for paper and credit cards
- 8 Light barrier

Operating and display elements

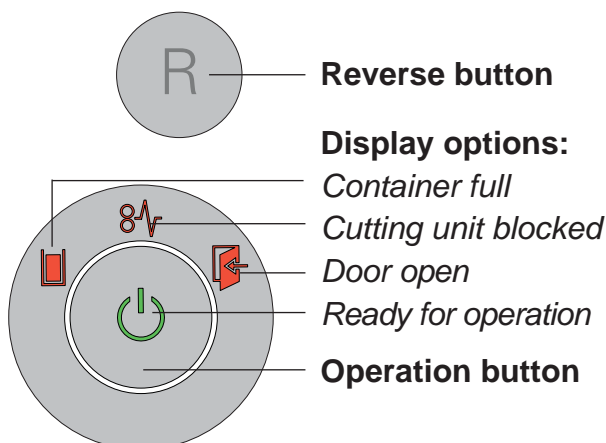

4 Operation

Switching on the shredder

- Set mains switch at rear of paper shredder to „I“.
- Press the operation button.
- The “Ready for operation” indicator lights up.

Shredding paper

- When you feed paper, the light barrier automatically starts the cutting unit.
- Two seconds after the light barrier in the paper feed opening is free again, the cutting unit is switched off automatically and the shredder switches to standby.

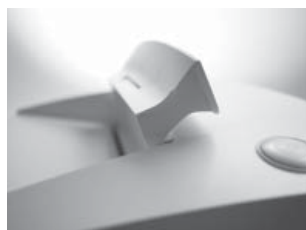

Note:

You can fold the safety element upwards to shred larger quantities of paper. This makes it easier to access the feed opening.

Shredding CDs

(only in cut size: 3.9 mm, 5.8 mm, 4.5x30 mm)

- Switch the shredder to permanent mode: Press the operation button for four seconds.

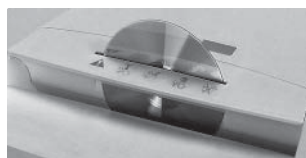

- Only feed the material into the insertion slot of the safety element (splinter protection).

- Switch off permanent mode: Press the operation button.



Note:

To completely separate the materials shredded, you can insert the CD bag supplied.

Shredding credit cards

Feed the cards through the CD slot when the cut size is 3.9 mm, 5.8 mm, 4.5x30 mm. For other machines, use the opening for paper.

Switching off the shredder

- Press the operation button.
- The “Ready for operation” indicator goes out.
- Set mains switch at rear of paper shredder to „0“.

Other function modes:

- **Brief mode 10 s**

Application: Shredding foils, credit cards and small bits of paper

Function: The cutting unit runs for approx. 10 seconds and is then switched off automatically.

Start: Press the operation button for two seconds.

Premature cancellation: Press the operation button.

- **Permanent mode**

Application: Shredding CDs and large quantities of paper and foils

Function: Cutting unit runs continuously.

If no material is fed in within a period of 2 minutes, the cutting unit shuts down and the shredder switches to standby.

Start: Press the operation button for four seconds.

Premature cancellation: Press the operation button.

- **Sleep mode**

Function: Two minutes after the last paper feed operation, all consumers that are not required are switched off automatically.

The "Ready for operation" indicator flashes briefly at regular intervals.



The shredder starts automatically when paper is fed in.

- **Automatic shutdown**

Function: If the shredder is not used for four hours, it shuts down completely and therefore does not consume any more electricity (at night, at the weekend).

Restart: Press the operation button.

5 Troubleshooting

Display	Problem	Measure
	Paper jam	<p>You have fed in too much paper.</p> <ul style="list-style-type: none"> ➤ The cutting unit runs in reverse for a few seconds and pushes the paper back out again. • If necessary, press the reverse button "R" to remove the stack of paper. • Take half the stack of paper. • Feed the paper in portions. <p>Note: This indicator lamp also lights up when the motor is overloaded. In this case, let the shredder cool down for 20 minutes before using it again.</p>
	Shredded material container full	<ul style="list-style-type: none"> • Empty the shredded material container. <p>Note: If you press the reverse button briefly before opening the door, part of the material is pulled back into the cutting apparatus.</p>
	Door open	<ul style="list-style-type: none"> • Close the front door.

6 Cleaning and maintenance

Switch off the shredder and pull out the mains plug. When cleaning only use a soft cloth and a mild soap-water solution. However, no water must enter the equipment.

Check that the door switch is working properly:



Warning!

If the following procedure cannot be performed, switch off the document shredder, disconnect the mains plug and contact customer service.

- Insert the mains plug and switch on the shredder.
- Feed in a sheet of paper and open the front door while the paper is being drawn in.
 - The cutting unit must turn off immediately and the “door open” indicator must light up.
- Close the door.
 - The cutting unit must not yet restart.
- Pull the paper out of the feed opening. The light barrier must be clear.
- Switch off the machine and then switch back on.
 - The cutting unit starts when paper is fed in.



Oil the cutting unit when cutting performance decreases or the device becomes noisy, or every time you empty the waste container (Cross cut only):

- Spray special cutting block oil through paper feed opening across the whole width of the cutting system blades.
- Let the cutting unit run without paper in brief mode.
 - Paper dust and particles are shaken off.

Note:

Oiling the cutting unit also improves the cutting performance of devices with strip cut.

7 Scope of delivery

- Document shredder, ready for connection, packed in a carton
- 5 waste bags
- 1 CD bag for machines with cutting widths 3.9 mm / 5.8 mm / 4.5x30 mm
- 1 bottle of special cutting apparatus oil (50 ml) for devices with particle cut
- Operating instructions

Accessories:

- Waste bag, order no. 1.330.995.000
- Special cutting apparatus oil (250 ml) order no. 1.235.997.403

8 Technical data

Cutting type	Strip cut		Cross cut	
Cut size (mm)	5.8	3.9	4.5 x 30	1.9 x 15
Security level DIN 32757 - 1	2	2	3	4
Cutting capacity (sheets), A4	70 g/m ²	31 - 33	25 - 27	20 - 22
	80 g/m ²	27 - 29	22 - 24	17 - 19
Weight	34.5 kg		42 kg	
Cutting speed	88 mm/s		80 mm/s	
Intake width	310 mm			
Power supply	230 V, 50 Hz		100 V, 50/60 Hz – 115 V, 60 Hz	
Power consumption with max. number of sheets	650 W		650 W	
Size W x D x H (mm)	541 x 439 x 845			
Shredded material container volume	100 litres			
Noise emission (idle running / under load)	56 dB(A) / 59 - 63 dB(A)			

EC declaration of conformity

Machinery directive 98 / 37 / EC
 EMC directive 89 / 336 / EEC
 Low voltage directive 73 / 23 / EEC

The manufacturer – **HSM GmbH + Co. KG**, Bahnhofstrasse 115, D-88682 Salem, Germany – hereby declares that the document shredder **SECURIO B34** complies with the EC directives listed above, including all modifications that apply.

Applied standards and technical specifications:

- EN 55014-1:2000 + A1:2001 + A2:2002
- EN 55014-2:1997 + A1:2001
- EN 61000-3-2:2000
- EN 61000-3-3:1995 + A1:2001
- EN 61000-4-2:1995 + A1:1998 + A2:2001
- EN 294:1992
- EN 61000-4-4:1995 + A1:2001 + A2:2001
- EN 61000-4-5:1995 + A1:2001
- EN 61000-4-6:1996 + A1:2001
- EN 61000-4-11:1994 + A1:2001
- EN 60950-1:2006

Salem, 02.08.2007



Rolf Gasteier - Technical Director

The machine type was tested for compliance with the requirements of the EC Machinery Directive by the test and certification board of the Technical Administration Committee, c/o Verwaltungs-Berufsgenossenschaft, Deelbögenkamp 4, D-22297 Hamburg, Germany. This test centre is responsible according to Appendix V of the EC Machinery Directive.